

FOR PLAYERS OF VIOLIN, VIOLA, CELLO, BASS, AND FIDDLE

STRINGS

February 2006

news &
NOTES

Wine Country Concert Hall

Amid the clack of a towering pile driver, and the strains of symphony musicians, groundbreaking for the **DONALD AND MAUREEN GREEN MUSIC CENTER** got underway this past fall. The \$47 million venue—located on the Sonoma State University campus in the heart of Northern California Wine Country—is fashioned after the Boston Symphony Orchestra's

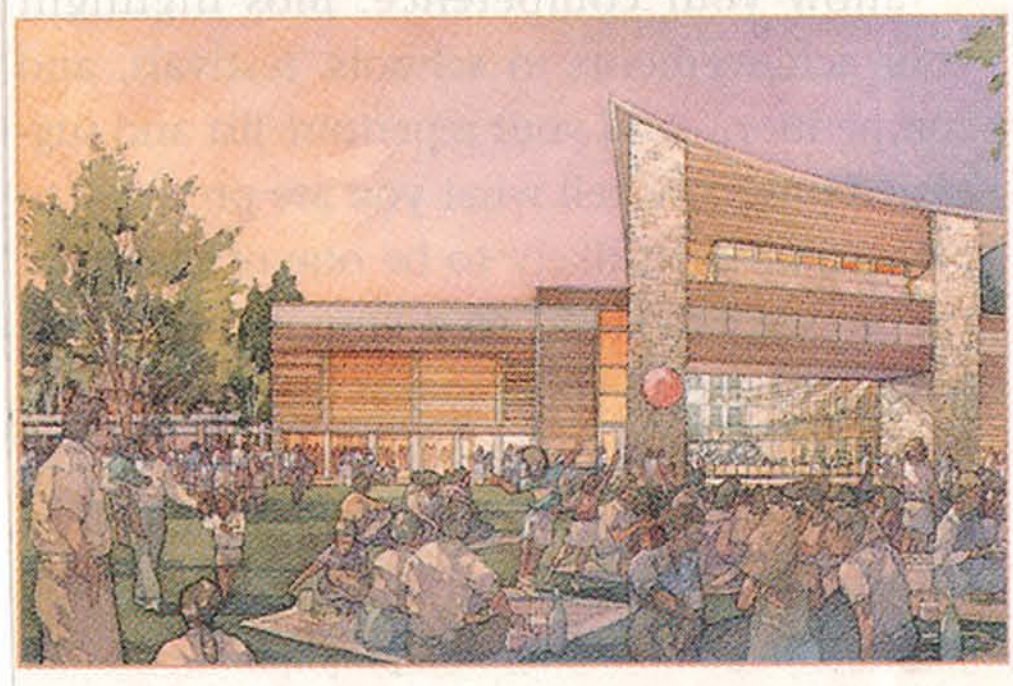

GREEN DAY: Wine-country music hall.

summer home at Tanglewood. The sprawling complex will provide a new home for the **SANTA ROSA SYMPHONY**, as well as classrooms for SSU music, dance, and theater students. The seed money for the project came from technology magnate Donald Green, an amateur musician, with the university donating land and a portion of the funding. Former SRS conductor **JEFFREY KAHANE** serves as music director at the Green Center's annual summer-music festival.

The project has sparked a storm of controversy. Opponents, including SSU faculty members, criticized SSU President Ruben Armiñana, whose wife serves on the SRS board of trustees, for pushing through the project at a time when the cash-strapped campus was cutting educational programs. The music center is scheduled to open in 2008.

—Greg Cahill